

Catalog 107

THE COLORADO TENT

Est. 1890

Sportsmen and Outfitter Products Since 1890

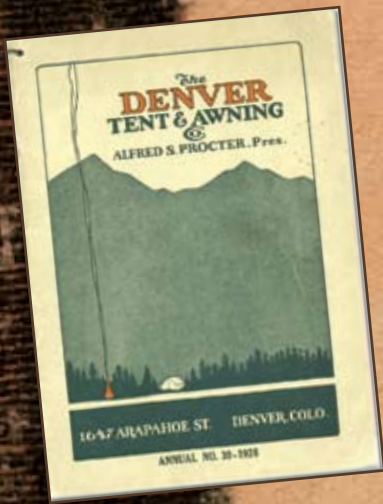

About Our Company

Welcome! We are proud to bring you our 107th edition of our Sportsmen and Outfitter Products Catalog. You'll see new products, enhanced background information and many helpful hints. Also, we have changed the name of the Colorado Tent Company to the Denver Tent Company, reflecting Denver Tent's acquisition of Colorado Tent in late 2005. We are now one of the largest wall tent manufacturers in the nation and 100% of our sportsmen and outfitter products are built in the USA. Colorado Tent now becomes our lead brand name for a broad line of sportsmen and outfitter tents.

Denver Tent History

January 1, 1890

Alfred S. Proctor started Denver Tent & Awning Company. Ten Cornell University graduates each invested in the company. Mr. Proctor successfully directed the company for over 40 very prosperous years.

1939 - 1966

The company merged with the Brooks Company but retained the Denver Tent name. In 1945, the Denver Tent & Awning Company was sold to Ralph Avery, a Federal Inspector of War Plant Production.

The company was sold to Medalist Industries in 1966 and again to Ernie Hagler, an icon in the tent-fabric industry, in 1969. Ernie owned the business for over 22 years. A few of Ernie's employees are still with the company and speak fondly of his personable nature and leadership skills. In the early 1990's, the company shortened it's name to Denver Tent Company, reflecting a change in manufacturing focus.

2004

ACC Acquisition, purchased Denver Tent Company in 2004. ACC Acquisition invests and owns companies that exhibit a strong heritage and provide a long term sustainability in quality, value, reputation and customer satisfaction. This is exactly why Denver Tent Company is owned by ACC.

Both companies have been manufacturing the highest quality tent, custom fabric and other outdoor products since 1890 and we thought combining forces would allow us to fulfill our vision more efficiently and effectively. That vision is to be the premier tent and outdoor products resource in the industry by offering exceptional quality, trusted advisory, and unparalleled customer service at competitive pricing for our customers that will create for them safe shelter and wonderful outdoor events and a lifetime of great memories. In short, we want to be your trusted partner in the great outdoors!

Thank you for your consideration. The key ingredient to our success and longevity is ultimately you, our customer. Please do not hesitate to contact us and give us your input and thoughts, so we can continue to improve our products and services for you. You can email, call or visit our showroom and manufacturing facility here in Denver Colorado.

On behalf of Denver Tent Company and its entire staff,

Dave Schunk, CEO



Purchase Considerations

Size

Your first decision should be the size of the tent you will need. If it's too small, you will not be comfortable and a tent too large can be frustrating. Generally speaking though, bigger is better.

If this is your first wall tent, plan carefully how and who will be using it. Our scaled drawings to the right offer ideas on how much space you may need. We suggest using a 24 – 30 sq. ft. per person formula. This formula allows for extra space and takes into account other items that may also be in your tent: stove, table, chairs, cots and gear.

Fabric

The fabric you choose may be as important as the size of the tent. Our many fabric options all offer excellent protection from the elements and help maintain a comfortable interior climate. All are very durable fabrics and with proper care, will last for many years. (Page 3)

Pole Set or Frame

This age old question really comes down to personal preference. Some may opt for the Pole Set option based on weight or cost factors. While others opt for the Frame when the wall tent is being used long term or there is a need to maximize space or for better organization. Either option allows for a great camping experience. (Page 6)

Features

Our many years of experience in the tenting industry have helped identify which key features are a must in any wall tent. In addition to expert craftsmanship and utilization of the highest quality fabric, Colorado Tents have these features:

- *Fiberglass stove pipe shield with 4", 5" or 6" opening with a zippered stove pipe shield cover that seals out summer rains and winter snows*
- *Ridge pole opening with zippered closure*
- *9" vinyl sod cloth sewn in the bottom of all wall tents that acts as an air seal and helps keep the tent warmer and free of debris*
- *3" eaves reinforced with seatbelt webbing and double rolled rim grommets at seam*
- *Reinforcement at all corners and stress points*

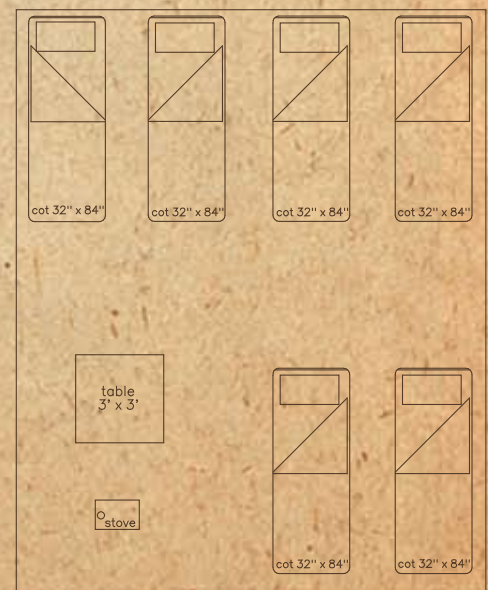
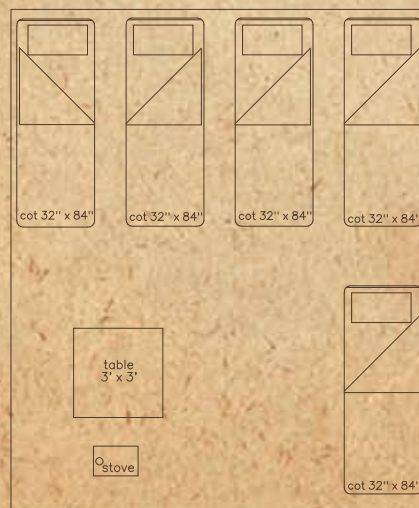
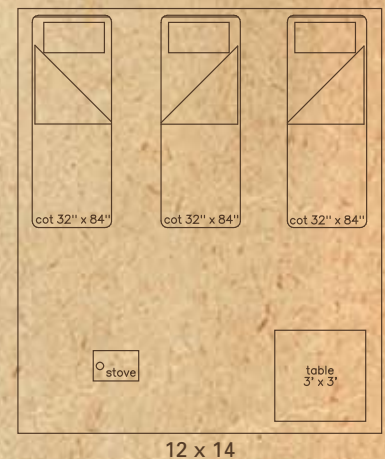
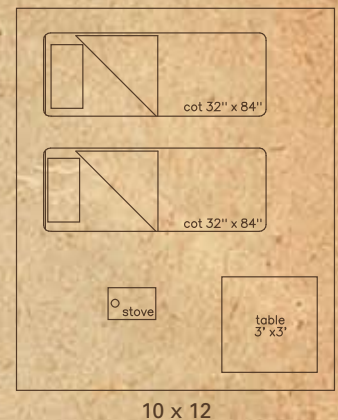
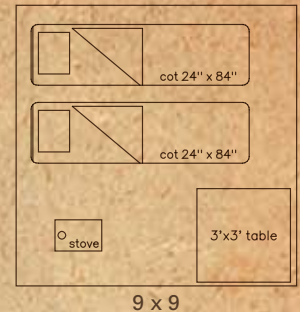

Fabric Choices

Army Duck - Army Duck is a plied-yarn fabric weighing 10.10-oz. or 12.63-oz. per square yard. Two pieces of yarn are spun together in the fill creating the double-fill duck. The double-fill duck (Army Duck) is a dense fabric with a tight weave that is preshrunk. We purchase only the highest quality Army Duck with a Sunforger® finish that provides mildew resistance and water repellency. (Both weights also come in a flame retardant CPAI-84 certified version.) Generally, 10.10-oz. Army Duck is our preferred traditional fabric.

Natural Canvas - We use a 14.90-oz. weight for its durability and insulating qualities. It is a flat weave cotton cloth with single yarns in both warp and filling. The warp yarns are woven in pairs side-by-side and are predominant over the filling yarns, producing a cloth highly resistant to tear and abrasion. While not treated with a waterproof compound, natural canvas is naturally water repellent through its construction.

Polaris - This fabric is a 11-oz. 50/50 polyester/cotton duck that is finished with a water, mildew and flame resistant coating. It has a high tensile strength and tear resistance. Polaris has an excellent cold crack rating for those extreme conditions and is recommended for long term set ups. UV stabilized and breathable.

WeatherMAX® - This 6.5 or 8-oz. product has been specifically designed for extended outdoor use in all seasons. Made of uncoated, solution dyed, never fade yarn, WeatherMAX® provides UV resistance, breathability and superior water repellency. WeatherMAX® fabric is 30% lighter in weight than standard canvas fabrics and has greater tear and abrasion characteristics.



Caring For Your Colorado Tent

Packing It Away

Colorado Tents, when maintained properly, can last up to 30 years. You should always store your tent loosely packed, clean and dry in a cool environment. If put away damp or dirty, one of the most common problems that can occur in canvas is mildew. If your tent starts to mildew, it should be opened up, thoroughly dried and cleaned. However, some mildew is inevitable and is usually not a problem. You can clean your tent with a 9:1 water to bleach solution or a mild detergent. Use a soft brush or broom to scrub the affected areas.

Direct Light

Ultraviolet light can degrade some tent fabrics. UV light will cause the fabric to fade, lose strength and eventually disintegrate. The amount of UV damage is directly related to the fabric's exposure to the sun and the altitude at which the tent is pitched. The best way to prolong the life of your tent is to use a tent fly, pack it properly, and pitch it in a shady spot as much as possible.

Leaks

New tents sometimes leak when they are initially exposed to moisture. Don't worry, this is not unusual. You may consider preconditioning your tent by setting it up and soaking it to shrink the needle holes tightly against the thread.

Precipitation

Any type of precipitation should not be allowed to accumulate on your tent. The easiest and most cost effective way of handling rain or snow is a simple tent fly. The fly helps protect the tent from sparks, UV rays, increases breathability and insulation and provides a water resistant surface.

Guy Ropes

Always set up your tent using all the guy ropes and stakes provided. In windy or adverse conditions, we recommend frequently checking the guy ropes and stakes.

Our Products

We have built the highest quality outdoor fabric products for outfitters, professional camping organizations, governments, ranchers, outdoor enthusiasts, cowboys and recreational sportsmen since 1890. Our commitment to quality has never wavered. Simply put, our products combine the best of long-term historical experience, craftsmanship and knowledge with the latest technologies in fabric, materials and construction techniques. Our products have been tried and tested over long periods of time and in extreme environments; from the high altitude and high wind environments of our home here in Colorado to the frozen tundra of Alaska and the sweltering desert sun and heat of Arizona.



The Colorado Wall Tent is our flagship, all-purpose, all-terrain tent that is used world-wide by ranchers, campers, cowboys and sportsmen. It has the widest variety of options and customization of any of our tents. Also check out our newest product, **The Colorado Lodge Tent**. Pages 5 - 7.



The Colorado Range Tent is the proven design and continued choice for the working ranch cowboy. Recreational users love it as well. It sets up quickly and is an excellent shelter in bad weather. Page 8



The Colorado Herder Tent is an economical Wall Tent with a center-pole. It combines the comfort of a Colorado Wall Tent with the ease of set up of a Colorado Range Tent. Page 9



The Colorado Cheyenne/Sioux Tipi is our most popular tipi. It combines the original and authentic historical Cheyenne/Sioux design with modern fabric and options to make it the best tipi on the market today. Page 10



The Pop-up and Party Canopy make excellent reception/cooking areas and are lightweight and easy to use temporary shelters. Take a look, you'll love them! Page 11



Outfitter and Sportsmen accessory products including flies, tarps, bags, stakes and so much more. We also provide best-in-class repair, storage and advisory services. Pages 12 - 16

The Colorado War Tent



Sizes	Center Height
9' x 9'	7'- 7"
10' x 12'	7'-11"
12' x 14'	8'- 3"
14' x 17'	9'- 2"
16' x 20'	9'- 8"

5' side wall standard

Fabric Choices
 14.90 oz. Duck Canvas
 10.10 oz. Army Duck
 10.10 oz. Army Duck (CPAI-84)
 WeatherMAX®

Options
 Screened windows - triangular or rectangular
 Extra door
 3-way zipper door with heavy duty #10 YKK zipper
 Screen door - commercial grade fiberglass screen
 Tent floor - 10 oz. FR vinyl
 Tent fly - 10 oz. FR vinyl or 5.2 oz. reinforced poly
 Pole set - 1 3/8" galvanized steel tubing
 Frame - 1.315" Top Rail galvanized steel tubing
 Cook shack

Our flagship canvas tent, The Colorado Wall Tent is a tried-and-true descendant of our classic Woodsman Tent. The Colorado Wall Tent is a favorite of hunters and outfitters wanting a reliable and comfortable base camp. The Colorado Wall Tent has evolved over the years from hundreds of suggestions from professional outfitters and guides who realize a tent is more than just a place to sleep. As offered, the standard tent has everything you need for great camping but can be customized to meet your specific requirements. Our Colorado Wall Tent has a legacy and history all its own. Our tents stand the test of time and will give you many, many years of memories and use.

The wall heights are a true "finished size" but other dimensions listed are cut sizes. This tent works equally well on the ground as it does on a deck. Custom sizes available, please call for quote. (Frames and pole sets sold separately.)



1 Ridge pole opening with #10 YKK zipper closure



2 Vertical zipper with Fireman's snap and D-ring closure and weatherflap



3 Fiberglass stove pipe shield, with 4", 5" or 6" silicone rubber ring



4 3" eaves reinforced eaves with seat belt webbing, double spur grommets



5 9" sod cloth



6 Reinforced corners and seams



Frame

Our free standing frame is the best in the industry. Made of 1.315" diameter Top Rail galvanized steel tubing, our frames offer durable, affordable and easy construction. The frame option requires NO tools (reducing set up time), maximizes your living area and provides a useful way to hang your camping items. Extremely strong, but very lightweight, 3-way and 4-way joints join the steel tubing. The joints are made to the angle of the tent and will not loosen. The longest piece on most tents is 63". Includes storage/carrying bag.

Pole Set

An excellent alternative to the steel frame option, our ridge poles/uprights are constructed of 1 3/8" galvanized steel tubing. The wall poles are thumbscrew tightened, adjustable aluminum and can accommodate up to a 6' wall. The ridge pole and uprights are jointed for easy disassembly and transport. Our pole set can be packed in and easily set up. Includes storage/carrying bag.



"I wanted to let you know that we had bought one of your tents about three years ago, and it recently met it's demise not in the field, where it performed beautifully, but while in storage when it was drowned in a sewage leak. I am happy to be able to make such an easy decision to order another."

Anne E. - Stanford University

The Colorado Lodge Tent

The Colorado Lodge Tent has been uniquely designed for luxury and comfort with the revolutionary WeatherMAX® fabric in mind. The Colorado Lodge Tent has been field tested under diverse conditions and has outperformed our wildest expectations. The key to The Colorado Lodge Tent's success is the WeatherMAX® fabric. (See page 3) Over a century of tent making experience has gone into The Colorado Lodge Tent construction. We've taken the best of traditional manufacturing techniques and combined them with state-of-the-art materials. This winning combination gives you the ideal outpost experience that you've been looking for all these years. We're still avid fans of our canvas products but if you're serious about outdoor adventure, this tent is guaranteed to outperform any other tent on the market. We're so confident in The Colorado Lodge Tent's ability to stand up to the most rugged environments – whether it's a week or many months in the sun or snow – The Colorado Lodge Tent comes with a 5-year fabric warranty and a two-year workmanship warranty from Denver Tent.



Sizes	Center Height
10' x 15'	7'-11"
12' x 15'	8'- 3"
16' x 20'	9'- 8"

5' wall standard

Fabric Choices
 8 oz. WeatherMAX® 80
 6.5 oz. WeatherMAX® LT
 WeatherMAX® FR (NFPA-701)

**Everything you need to set up
 The Colorado Lodge Tent is included:**

- WeatherMAX® fabric
- 3-way zipper full screen door
- Clear vinyl / fabric closures on all windows
- Attachable vinyl floor
- Internal steel frame
- 5" stove pipe shield
- Ropes and stakes
- Tent, frame and stake bags

The Colorado Range Tent / Cowboy Tipi

The Range Tent (Cowboy Tipi) has been in our catalog since 1916! Its proven design is the continued choice of the working ranch cowboy. It is also popular with campers who want a tent that sets up very easily and quickly. It has proven to be excellent shelter in bad weather. The Range Tent can be supported with one internal center pole, a two-pole external pole set, or the peak can be hung from a tree limb. We recommend the external pole set: the tent sets up better and eliminates the pole in the middle of your tent.



- The Range Tent includes:**
- 2 Way Zipper with snap and D-Ring Closure
 - 10 oz. vinyl sewn-in floor
 - Steel Stakes and Stake Bag
 - Ropes and Rope Tightners
 - Tent Bag

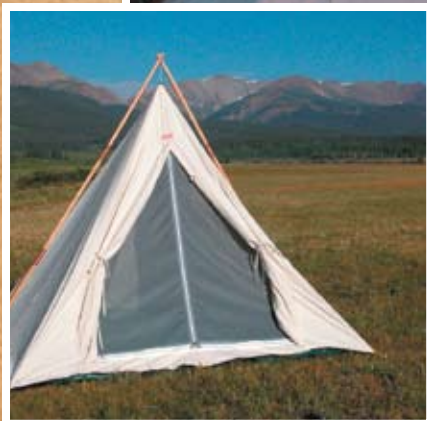

"I bought a hunting tent from Denver Tent and Awning Company on about July of 1978. It has served me well... the workmanship has held up beyond my expectations for almost 30 years. These are "back home" folks that still care about their product and a relationship with a customer."

Jerry D. - Golden, CO

Sizes	Center Height
6' x 8'	7'- 3"
7' x 7'	6'-10"
8' x 8'	7'- 0"
9'-6" x 9'-6"	7'- 6"
12' x 12'	9'- 4"

Fabric Choices
14.90 oz. Duck Canvas
10.10 oz. Army Duck
10.10 oz. AD FR (CPAI-84)
WeatherMAX®

Options
Webbing Ties (in place of zipper and snaps)
3 way zipper door, no screen
3 way zipper door, with screen
Triangle screened window in rear wall
External Wood Pole Set

The Colorado Herder Tent

The Herder Tent is a more economical version of our wall tent with center-pole that is very easy to set up. It is great in high wind areas and easy to pack. The square wall tent provides more livable room because of the higher wall. The smaller sizes, 8'x8' and 9'x9', do not require side poles. The larger 10'x10' and 12'x12' sizes require side poles because of the higher wall heights.



The Herder Tent includes:

- 3-way zipper door with snap and D-ring closure
- weather flap
- 9" vinyl sod cloth
- Steel Stakes and Stake Bag
- Ropes and Metal Rope Tightners
- Tent Bag



WeatherMAX® Herder Tent

"I'd rather be in a tent than in a house."

Mary Leaky - Archaeologist

Sizes	Wall Height	Center Height
8' x 8'	2' - 6"	6' - 6"
9' x 9'	2' - 6"	6' - 11"
10' x 10'	4' - 0"	9'
12' x 12'	5' - 0"	11'

Fabric Choices

- 14.90 oz. Duck Canvas
- 10.10 oz. Army Duck
- 10.10 oz. AD FR (CPAI-84)
- WeatherMAX®

Options

- Screened Door
- Stove Pipe Shield (4", 5", 6")
- Side Poles; adjustable aluminum (4' and 5' walls only)
- Screened window, triangle or square
- Snap-In Floor: 10 oz vinyl

The Colorado Cheyenne / Sioux Tipi

Patterned on authentic Indian designs, we proudly offer the Colorado Cheyenne/Sioux Tipi. The Cheyenne and Sioux tribes lived in close proximity in Colorado and parts of the West and had much in common, including their tipi designs. Our pattern incorporates the best of both tipi styles. Historically accurate, our tipis are still used today by the Utes, Navajos and Kiowas as ceremonial tipis. The Cheyenne/Sioux is our most popular tipi.

We also offer another version of the classic Indian tipi - the Arapahoe Tipi. The Arapahoe Tipi style incorporates a more vertical rear profile that was designed to counter the force of the high winds of the eastern Rocky Mountains and other windy areas. Please call for product availability and pricing.

Tipis includes:

- Finished bottom and door flap
- Hardwood stakes and bag
- Smoke flap guy ropes
- Lacing pins
- Tipi storage bag

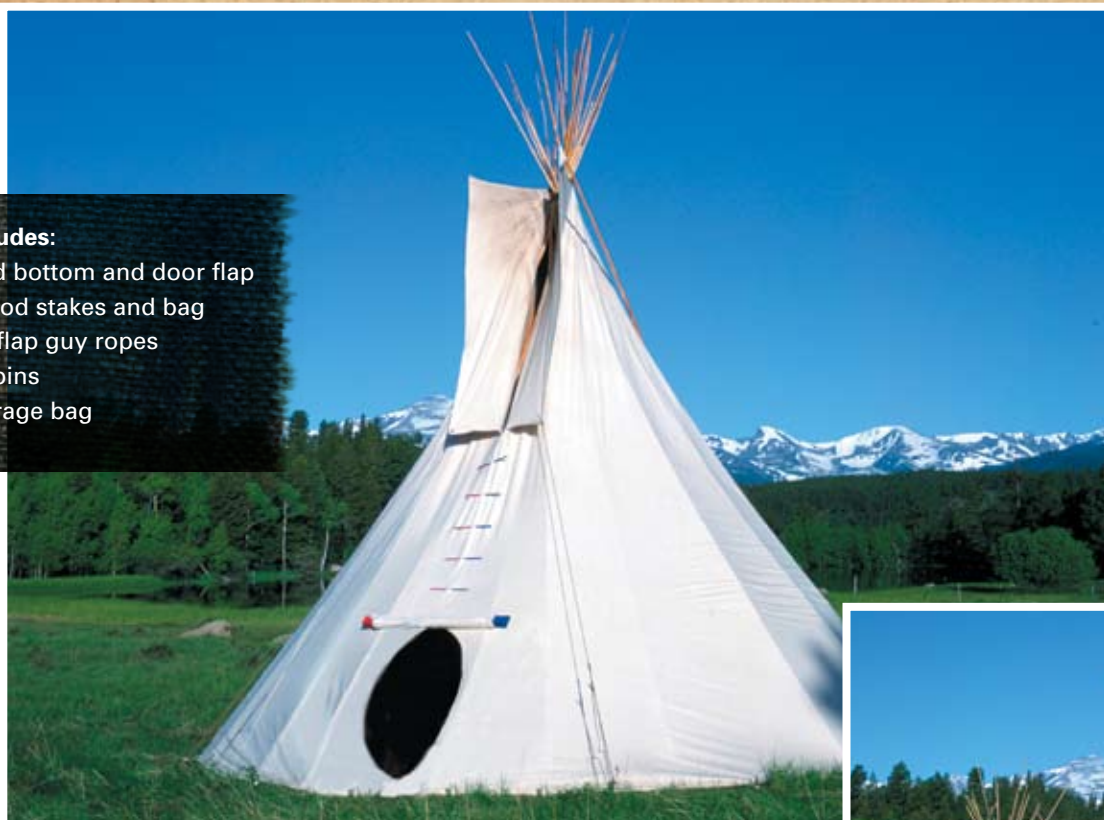

Colorado Cheyenne/Sioux Tipi



Colorado Arapahoe Tipi

"The best living shelter ever conceived for extended outdoor living"
 Ernest Thompson Seton - Author/Artist

Sizes (diameter)

- 12'
- 14'
- 16'
- 18'
- 20'
- 22'
- 24'

Fabric Choices

- 14.90 oz. Duck Canvas
- 10.10 oz. Army Duck
- 10.10 oz. AD FR (CPAI-84)
- WeatherMAX®

Options

- Poles
- Door style: oval door, inverted "U" door or no door cutout
- Liner

Pop Up

Tired of pop ups that last for one or two outings? Are you looking for a commercial grade, tough pop up, one that will stand up to the rigors of your camp? You can stop looking. We have tried and tested many brands and The Denver Tent Undercover Pop Up was the only one that met our rigid requirements for strength, portability, ease of use and quality.

The pop up is a temporary, very light weight and portable tent structure perfect for backyard parties, swim meets, BBQ's and for cooking or group gatherings in camp.



The Denver Tent Undercover Pop Up includes:
Anodized Aluminum 1 1/4" jumbo sized telescopic legs
Chan-X™ Honeycomb Channeled Scissors bar
Dial-A-Fit™ Peak Extender and Inner-Truss™
Dynamic Balance Peak System
Heat Reflective Sit-X™ 600-D Poly Skin, UV protection
Wheel Spin-Bag and Banana-Peel Entry
Peak Height 11' 6"- folded 62"x10"x10" (10x10)
Two year limited warranty

Pop-Up Options

10'x10' walls included
10'x15' walls not included
10'x20' walls not included
Custom Colors and camouflage
Logos and printing services
Walls - Netting
Walls - Solid

Party Canopy

As the name implies, this is a tent to have a party in. And we know that outfitters, campers, cowboys and outdoor enthusiasts like to party while they are in the great outdoors! This tent, with or without mosquito netting walls, is perfect for cooking or relaxing after the day's hunt or pack trip is done. Reliable, durable and affordable, Denver Tent has been making this tent since 1960 and is one of the largest Party Canopy makers in the USA.

The canopy is made out of Snyder PVL PermaBar™ 11oz. vinyl. This is a tough, long-lasting fabric that has a 9x9, 500x500 denier scrim and it comes in white or a variety of 30" color stripes. This fabric is Fire Retardant and meets NFPA 701, CPAI 84 and CA Fire Marshal standards. All seams are reinforced at all stress points and the tent has 3.5 ft. long by 1.25 ft. diameter anodized aluminum sectional side poles that are used to build the wall and center heights. This tent is very easy to port and set up.



The Party Canopy includes:

Canopy Top
Aluminum Sectional Poles
Steel Stakes and Stake Bag
Ropes and Rope Tightners
Tent Bag

Colors

Solid white; white with red, blue, green and yellow stripes.

Sizes

10' x 10', 15' x 15', 20' x 20', 20' x 30', 20' x 40'

Options

Poly and mosquito net walls
Camouflage and other custom fabrics

Accessories

We have a full line of outfitter and sportsmen accessory products and services for maintenance, repair, replacement and upgrading of your outdoor products. Whether we make it or market it from our partners, you can rest assured that we have tested and tried it out ourselves to ensure that the quality has gone in before we put it on our shelves!

Cowboy Bed Tarp

Originally listed in our 1925 catalog as Cowboy Waterproof Bed Sheets or Tarps, the Cowboy Bed Tarp is one of many items we have been manufacturing since the turn-of-the-century. Still used today for sleeping on the open range, the Cowboy Bed Tarp's long length is designed to hold a sleeping bag or blankets, gear, clothing, boots and still have enough length to cover your head if it rains. Our Cowboy Bed Tarps are made from either a lighter weight 12-oz. Duck Canvas or a heavy duty 18-oz. version. Metal D rings and snap hook fasteners are used to close the Cowboy Bed Tarp up to the desired size or it can be opened up flat for easy packing or for use as a ground tarp.



Cook Shack

The Cook Shack extension attaches to one end of your wall tent to separate cooking from the sleeping area. It includes a stove pipe shield with zipper closure flap. The end connecting to your tent is open and the other end has a vertical zipper in addition to snap and D-ring closures. Please note the Cook Shack comes in 10.10-oz. Army Duck Canvas.

Tent Fly

Our most durable tent fly is made of 10 oz. white WeatherSpan®, a water repellent, tear and mildew resistant, flame retardant reinforced vinyl fabric that not only protects your tent from UV and direct sun but will keep your tent warmer in the winter and cooler in the summer.

Our other tent fly option is made of a clear 5.2 oz. reinforced poly fabric. It is lighter and less expensive than the 10 oz. version but will probably not last as quite as long.

Both of our fly options extend 6" beyond the width and length of the tent, have reinforced grommet attachments, configure to alignment of the tent and include a stove pipe shield access (if needed), guy ropes and rope tighteners.



Screened Window

Our most popular option, a screened window promotes cross ventilation for your tent. Made of woven fiberglass, this screen will not shrink, stretch or corrode. A zippered fabric flap is included on all windows. Zippered clear vinyl flaps also available.

Triangular – rear wall, 36" from top to bottom

Rectangular – side wall, 24"x30"

Accessories



Snap - In Floor

The Colorado Tent Snap-In Floor is constructed of flame retardant, waterproof 10-oz. vinyl-coated polyester and finished with snap-in hooks that match D-rings sewn into the wall base above the sod cloth. The floor can be easily snapped in and out for easy cleaning. Available in Forest Green for all tent sizes.



Camp Stoves

The name "Dog Stoves" comes from outfitters who calculated the night's impending temperature by how many dogs they needed in their tent to stay warm.

We feel the Dog Stove is the best stove in the business. Period. This stove includes: welded 3/32" heavy-gauge hot rolled steel with gasket-sealed door, two side shelves, stove pipe with damper, handles for carrying, and an internal baffle reducing the need for a spark arrester. Extremely portable as everything, including the legs, shelves and telescopic stove pipe fit inside the stove compartment.

"Our history with Denver Tent goes back some fifty years with the purchase of your camping tents...the tent is in original and excellent condition, the only thing not original are the tent stakes - must have pounded them into too many rocks over the years...certainly speaks well of the quality of a Denver Tent product after five decades of use."

Jack R. - Denver, CO

Stove	Size
Two Dog Stove	11"Wx11"Hx18"L
Three Dog Stove	12.5"Wx11.5"Hx24"L
Four Dog Stove	15.5"Wx11.5"Hx24"L
Hot Water Tank Option . .	6.5"Wx6.25"Hx23"L

What Size Stove?

- 2 Dog Stove: 9'x9' -12'x14'
- 3 Dog Stove: 12'x14' - 14'x17'
- 4 Dog Stove: 14'x17' -16'x20'

Keep in mind that the tent and stove size correlations listed above are only recommendations and will depend on how cold it is outside, how warm you want your tent to be, type of wood burned, etc. It is better to have a stove a little too big that can be closed down, than one that is not quite big enough.

Options

Hot water tank option with 4 gallon capacity, stainless steel construction and brass faucet on side.

Stove Mats - protect your tent floor from stray sparks. Made of FR fiberglass fabric. 4'x5'



Tent, Pole and Stake Bags

Tent Bags

Stake Bags

Pole Set Bags

8 Compartment Bags - handy for carrying smaller items that need organization.

Custom Bags - from canvas to vinyl and everything in between, call us, we can make it.

Poles

Adjustable aluminum side poles - one size fits 4', 5' and 6' sidewalls.

Steel pole sets - built of 1 3/8" diameter galvanized steel tubing steel pole sets include adjustable aluminum side poles for wall tents with guy ropes at every seam.

Ridge pole and uprights - are jointed for disassembly when transporting. Steel pins in top of uprights go through the ridge pole and ridge grommets on each end of the tent top. Center uprights are spaced appropriately along the ridge in larger tents.

Side Poles - Adjustable aluminum with thumbscrew for use in all of our tents. One pole fits 4', 5' and 6' walls. Packable length is 37".

Stakes

We offer various types of stakes for the many different types of terrains you may encounter. The angle irons are suitable for most conditions. The heavier duty steel hook stakes are better suited for rocky or hard surfaces.

Southern hardwood w/ notch	12"
Galvanized Steel angle-iron	12" and 15"
Steel Hook Stake	18"
Double headed Steel	1"x 36"

Ropes and Ratchets

We have a variety ropes and ratchets to safely secure your tent or tighten down your load.



Accessories



Tarps

Heavy duty and durable, our Colorado Tent Canvas Tarp (or mantle) is finished with #4 brass grommets in the corners and every 3' on all sides. Also makes a great pack cover. Several sizes available.

Fabric Choices

- 14.90-oz. Duck Canvas,
 - 10.10-oz. Army Duck
 - 18-oz. Unseamed Duck Canvas
- Custom fabrics and weights also available



"I have used this product for over 20 years...two of my friends saw me using the creel and how well it kept my fish us. their plastic bags. They asked me to get them two when I was home...they now use the creels too and are delighted with them."

Sohnms - Thurso, Scotland



Arcticreel

Introduced in 1940, the Arcticreel has become a necessary part of the basic gear for both the avid and casual fishermen. Functional, lightweight and easily carried through the underbrush or willows, the Arcticreel keeps your fish cool and fresh through an entire day of fishing. Made from flax canvas imported from Scotland, the Arcticreel works on the principle of the desert water bag. Evaporation greatly reduces the temperature within, keeping your fish in just out-of-the-water condition. A washable plastic liner insures a clean, fresh creel after years of use. The Arcticreel features anti-rust hardware and a waterproof flap sewn to the back of the creel to help keep the angler dry.

The Arcticreel features a large main compartment, a lined, zippered tackle pocket, adjustable shoulder strap and rings for attaching optional snap-on accessories.

- AC-220 10.5" x 14" x 4"
- AC-320 5" x 18" x 4"

Accessories

- Reel Pocket 5" x 5 x 2"
 - Snap Pocket 7" x 12"
 - Tackle Pocket 7" x 12"
- (zippered pocket large enough to hold extra line, flies, etc.)



All accessories are snap-on, detachable, and plastic lined.



Tear-Aid

A polyurethane elastomeric that resists puncture and tearing and is used for repairing torn canvas, nylon, rubber, plastic or vinyl. Clear, matte-finished, elastic patches are adhesive backed and all you do is clean the area (we recommend rubbing alcohol), peel and stick. This product is easily cut to customize repair. Sold by standard size patches or by the foot. Width is 3". Type A is for canvas, nylon, rubber or plastic. Type B is for vinyl. Be sure to specify which type when ordering.

Canvak

This is a canvas preservative that prolongs the fabric life and restores water and UV repellency of your older canvas product. It is an excellent product but we do not recommend it for use on newer, high quality canvas products that Denver Tent provides.

S-18 All Purpose Cement

Is a Neoprene super-strength adhesive for bonding leather, metal, rubber, canvas, glass, wood, fabric, tile and many other materials. S-18 is waterproof and resists temperature and weather extremes.

HH-66 Vinyl Cement

The ultimate vinyl to vinyl cement. Exceptionally strong, waterproof, weatherproof, bonds to all vinyl fabrics and most rigid plastics. Outstanding resistance to temperature and weather extremes. Excellent for sealing stitched seams.

IOSSO Products

Cleaning, mold and mildew removal, as well as seam sealing.

Repair, Storage, Cleaning Services

Denver Tent offers a full range of services including repair, storage and cleaning. Call or e-mail us for more information.





Order Form

To order you can fill out the information below and mail to **Denver Tent Company 4200 Garfield Street Denver, CO 80216** (or **fax it (303-399-1362)** to us. You can also go to our website at www.denvertent.com or call TOLL FREE at 1-800-869-7044 and our customer service representatives will be happy to fill out this form for you, answer any questions you have and send you a confirmation of your order.

Bill To

NAME _____
 ADDRESS _____
 CITY _____ STATE _____ ZIP _____
 PHONE _____ EMAIL _____

Ship To (if different than "Bill To")

NAME _____
 ADDRESS _____
 CITY _____ STATE _____ ZIP _____
 PHONE _____ EMAIL _____

PAGE	QTY	DESCRIPTION	SIZE	COLOR	UNIT PRICE	TOTAL PRICE	WEIGHT

TOTAL \$	
SALES TAX (COLORADO RESIDENTS 7.72%)	
SHIPPING AND HANDLING (SEE ENCLOSED ups WEIGHT SHEET)	
TOTAL ENCLOSED \$	

PAYMENT OPTIONS: CHECK VISA MASTERCARD AMERICAN EXPRESS DISCOVER

Card Number: _____ Exp. Date: _____ Security Code (CCV) _____

Name on Card (exact): _____

Denver Tent Company
4200 Garfield Street Denver, CO 80216

Custom Orders

We are happy to provide any customization that we can to your order. Pricing for custom orders is based on your specifications and a signed sales contract is required to begin production. A production schedule will be determined when the sales contract has been received and specifications confirmed. Also, confirmed custom orders may not be cancelled or changed. Custom orders must be paid in full prior to start of production.

Credit Terms

All orders must be paid in full, before shipping, unless you have prior credit approval. Terms are: n/30 days with approved credit. All business and/or personal checks may require a minimum of 7 business days for clearance before orders will ship. We reserve the right to withhold shipments or production of any order due to failure to satisfy credit requirements or pay any past due invoices. Past due invoices will be subject to collection costs, including, but not limited to, attorney's fees and court costs. Interest at one and one-half percent (1.5%) per month will be added on past due accounts. Disputed accounts must be submitted in writing within 30 days of invoice date for consideration. Credit approval may be periodically adjusted based upon your payment history with us. All NSF checks returned will be assessed a \$45.00 service fee.

Sales Tax

Sales tax will be charged on all applicable in-state orders unless tax exemption information is provided. A sales tax exemption form is required to be considered exempt for both city and state. Some entities may not be exempt from BOTH city and state. Denver Tax Law stipulates that if the entity is not tax exempt from the City and County of Denver, they are liable for Denver Sales Tax. If payment by check, check must be from the specified entity only - not from an individual or different entity. If paid by credit card, the entity is no longer eligible for tax exempt status.

Payment Methods

We accept American Express, Discover, MasterCard, Visa, certified/cashiers check, cleared check or money order, and cash before shipping. Your credit card will be processed at the time of the order. COD orders may be accepted as approved by Denver Tent.

Delivery Time

In most cases, we have products in stock and ready to ship. When we do need to manufacture an item, we strive to process orders and ship them in a timely manner (usually within three weeks), however our business is seasonal and our production lead times may vary. Factors that may influence production times include fabric and parts availability, customization and seasonality. Orders may be expedited, if required, for a fee. Unless instructed otherwise, we will select a transportation carrier for delivery.

Cancellations and Changes

Any order for our standard products, without modifications, can be cancelled prior to shipment. However, once the order is confirmed, there will be a restocking fee of 15%. Any custom order may not be changed or cancelled after fabric is ordered or if production has started. Changes to any confirmed order may incur additional charges based on the specific change. This charge is determined at time of change request.

Shipping and Handling

All orders will be shipped FOB plant of manufacture with freight charges either prepaid, collect, or charged to a third party. Typical carriers we employ are UPS or ABF Freight Lines. Shipping and Handling charges are determined at time of shipment, based on weight, cubic feet, and distance. An Energy/Fuel Surcharge will be applied to all orders. This helps to partially cover the increasing costs of fuel based manufacturing. Any products or components damaged or lost during transit are customer responsibility. The customer is responsible for filing claims through the freight carrier for any damaged or missing products. As a service, we may file freight claims for prepaid shipments as long as you inspect the shipment upon receipt and report any damage or shortages to us within 48 hours and have noted all damages and shortages on the delivery receipt when signing. Freight claims for third party and/or collect shipments are the customer's responsibility. Any damages incurred by freight carrier must be reported within 48 hours of receipt of product. All damages must be noted with the carrier upon delivery. Should a claim need to be filed, please contact us for instructions.

Return Policy

Returns must be authorized by us and requested within 30 days of receipt. A 15% restock fee will be incurred. No return request will be accepted after 90 days. Please contact our Customer Service department at (800) 869-7044 with return related questions. A return authorization number and request form must be obtained from us prior to returning merchandise. Merchandise must be returned new, in unused condition in original packaging, freight prepaid, with the RMA number. No products will be accepted as a return without an RMA# and written approval on the RMA request. A 15% restocking fee will be applicable for all approved returns. Custom orders are not eligible for return. We will not accept return shipments sent collect or COD. Tents that are received wet and/or dirty will be either rejected or assessed a cleaning fee.

Warranty

Denver Tent proudly warrants that our product will be free from defects in material and workmanship for a period of one (1) year following the date of purchase. Defects are limited to those resulting from the manufacturing process, and exclude holes, punctures or other damages which may occur during normal installation of a tent, whenever proper procedures are not followed. Certain material providers offer additional warranties on their fabrics, and where applicable, we will honor the additional fabric warranties. At our discretion, we will repair or replace defective product or any component of the product found to be defective during this warranty period. This warranty is valid for the original purchaser only, and is not transferable. This warranty does not cover normal wear or damage from improper or negligent use of the product, use contrary to instructions, repair or alteration by anyone other than Denver Tent or forces of nature. A dated proof-of-purchase receipt and completed Return Merchandise Authorization must accompany all returns. WARNING - Tent products are manufactured for use as a temporary structure and do not meet structural code, unless specified. Since weather is unpredictable, you must exercise your own good judgment, common sense and knowledge of local conditions with the installation instruction guidelines. You are responsible to anticipate weather severity for proper time and method of construction, appropriateness of product for the intended site as well as evacuation or disassembly details.



4200 Garfield Street
Denver, CO 80216

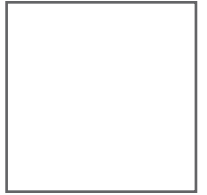

www.denvertent.com

P: 303.399.3232
800.869.7044
F: 303.399.1362

